



TDST SONESSE ULTRA 50 RA Range 1 - TECHNICAL DATASHEET

DOC141452

001

21/06/17 Page 1/2

Nominal voltage	230V - 50 Hz
Power supply tolerances	207 -253 V
Thermal time	4 minutes
Number of wires of the cable	4
Wire section	AWG 18
Insulation Class	Class I
Type of limit switch unit	Rapid Adjustment Limit switch
Capacity of the LSU	46 turns
Accuracy	< ±5°
System of protection (IP)	see chart below
Interface drawings	GEO143305 : Sonesse ULTRA 50 AC RA GEO130051 : Sonesse ULTRA 50 AC & DC Crown and Wheel Interface 206810 : Screw Implantation for LT50 mounting 206823 : Star Head LT50, LT50 PA/PS
Electromagnetic Compatibility	EN 55014 -1 EN 55014 -2
Environment scope	Interior applications Use
Temperature working range	see chart below
Noise Level	Power Level : according to standards ISO3741 in dB(A) re1pW Typical Value, at nominal torque, without application/end-product
Integration recommendations	<ul style="list-style-type: none">* The noise level depends upon the right fit between customers tubes and accessories, especially the crowns and the wheels.* Free plays have to be minimized between the accessories and the application tube to ensure the performance of the actuator.* Interior tube diameter must be > 47 mm - compatible with LT50 range crowns and wheels -* Crown as an interface with tubes is compulsory to ensure the performance of the actuator.* The stop wheel (ref : 9910004) must be screwed with a torque ranging between 1.5Nm and 1.8Nm.* Drive wheel must be riveted to the tube.* It's recommended to use the specific collapsable idler end cap (ref : 9019716 & 9019717) for silent result (do not use LT50 idler end caps).* Somfy Soft Clip drive wheel (brown in color; without rubber) are forbidden for this application.

	Nm / lbf	Nm	rpm	mm	mm	mm	mm	W	A	kg	lpxx	°C	dBA PW	
Designation	Nominal torque	Minimal Torque*	Nominal speed	L1 max.	L2 (±3 mm)	L3 max.	tube	Rated power	Rated current	Weight	Protection	Working Temperature range	Noise	Stop wheel
SONESSE ULTRA 50 6/20	6	0,4*	20	783	769	798	720	120	0,53	3	IP31	0°C to +60°C	38	mandatory

*: jumping effect prevention

Wiring	
Neutral	Blue
White button	Brown
Yellow button	Black
Earth	Green / Yellow

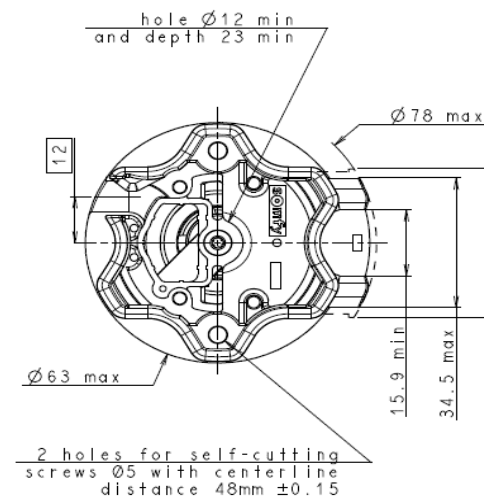
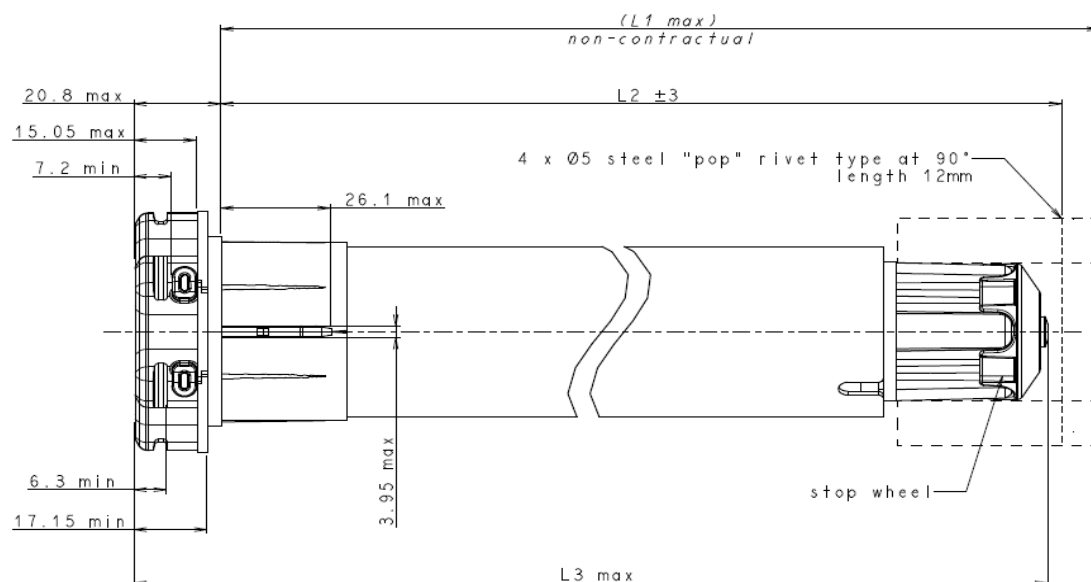

R & D

P. MICHEL

QUALITY

E. NOYER

AUTHOR

J. THIEBAUT